

INSTRUCTION SHEET OFF VEHICLE CARBURETOR SERVICE HOLLEY MODEL - 4150G

50-573-3

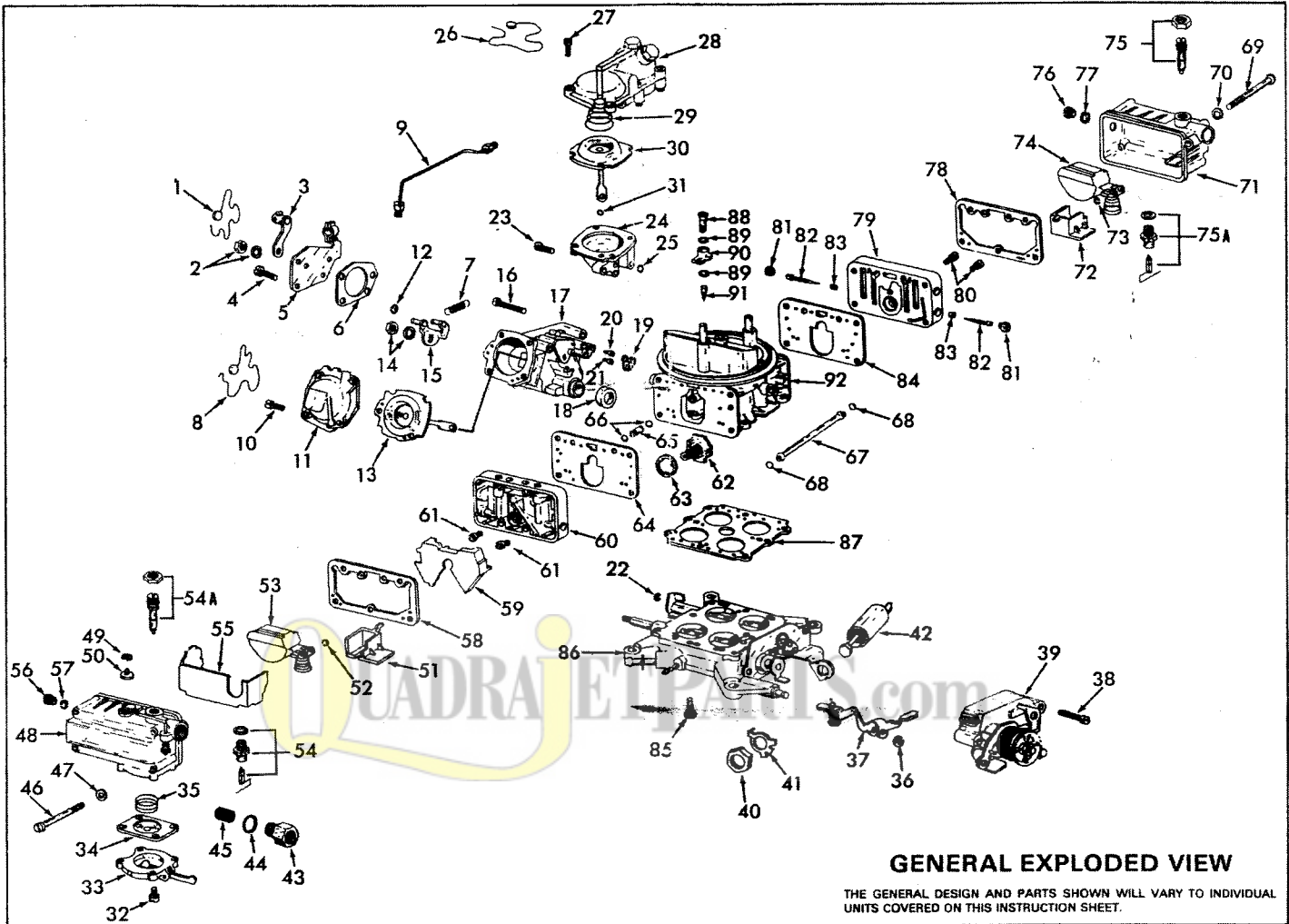

GENERAL EXPLODED VIEW

THE GENERAL DESIGN AND PARTS SHOWN WILL VARY TO INDIVIDUAL UNITS COVERED ON THIS INSTRUCTION SHEET.

DISASSEMBLY

USE EXPLODED VIEW AS A GUIDE. THE NUMERICAL SEQUENCE MAY GENERALLY BE FOLLOWED TO DISASSEMBLE UNIT FAR ENOUGH TO PERMIT CLEANING AND INSPECTION. NOTE: ON SOME MODELS UNHOOK HEAVY SAFETY SPRING ON THROTTLE LEVER ASSEMBLY (39) FOR EASIER ACCESS TO SCREWS (38) HOLDING ASSEMBLY TO CARBURETOR. RECORD JET SIZES AND THEIR LOCATION FOR REASSEMBLY.

NOMENCLATURE

REF. NO.	REF. NO.
1. SEAL & WIRE— COVER	28. COVER & VALVE ASSY.— SEC. DIAPHRAGM.
2. NUT & LOCKWASHER—LEVER	29. SPRING— SEC. DIAPHRAGM.
3. LEVER— CHOKE	30. DIAPHRAGM— SECONDARY.
4. SCREW & LOCKWASHER	31. BALL— SEC. DIAPHRAGM CHECK (SOME MODELS)
5. COVER—GOVERNOR HOUSING	32. SCREW & LOCKWASHER (4)—COVER
6. GASKET— GOVERNOR HOUSING	33. COVER ASSY.— PUMP.
7. SPRING— GOVERNOR	34. DIAPHRAGM— PUMP.
8. SEAL & WIRE— DIAPHRAGM COVER	35. SPRING— PUMP DIAPHRAGM.
9. PIPE— GOV. TO SEC. DIAPHRAGM COVER.	36. E-CLIP — LEVER.
10. SCREW & LOCKWASHER (4)— DIAPHRAGM COVER.	37. LEVER ASSY.— PUMP.
11. COVER— GOV. DIAPHRAGM.	38. SCREW & LOCKWASHER (2)— THROTTLE OPERATING SHAFT HOUSING.
12. E-CLIP- DIAPHRAGM STEM RETAINER.	39. HOUSING ASSY.— THROTTLE OPERATING LEVER.
13. DIAPHRAGM ASSEMBLY.	40. NUT— SOLENOID.
14. NUT & LOCKWASHER— GOV. LEVER.	41. LOCKTAB WASHER— SOLENOID
15. LEVER— GOV.	42. SOLENOID— THROTTLE
16. SCREW & LOCKWASHER (3)— GOV. HOUSING.	43. FITTING— FUEL INLET
17. GOV. HOUSING ASSEMBLY.	44. GASKET— FITTING
18. SEAL— GOV. HOUSING.	45. SCREEN— FUEL INLET
19. GASKET— GOV. HOUSING.	46. SCREW (4)— PRI. FUEL BOWL
20. JET "A" — GOV. HOUSING.	47. GASKET (4)— PRI FUEL BOWL SCREW.
21. JET "B" —GOV. HOUSING.	48. BOWL— PRI. FUEL
22. E-CLIP- SEC. DIAPH. STEM.	49. RETAINER— VENT VALVE
23. SCREW & LOCKWASHER (3)— SEC. DIAPH. HOUSING.	50. VALVE— VENT (SOME MODELS)
24. SECONDARY DIAPHRAGM HOUSING.	51. BAFFLE PLATE
25. GASKET— SEC. DIAPH. HOUSING.	52. E-CLIP - FLOAT
26. SEAL & WIRE— COVER.	
27. SCREW & LOCKWASHER (4)- COVER.	

REF. NO.	REF. NO.
53. FLOAT & SPRING ASSY.—PRI.	73. E-CLIP— FLOAT
54. NEEDLE & SEAT ASSY.—PRI.	74. FLOAT & SPRING ASSY.— SEC.
54A. NEEDLE & SEAT ASSY.—PRI. ADJUSTABLE (SOME MODELS)	75. NEEDLE & SEAT ASSY.— SEC.
55. BOWL FILLER— PRI (SOME MODELS)	75A. NEEDLE & SEAT ASSY.— SEC. ADJUSTABLE (SOME MODELS)
56. PLUG— FUEL LEVEL (SOME MODELS)	76. PLUG— FUEL LEVEL (SOME MODELS)
57. GASKET— PLUG (SOME MODELS)	77. GASKET— PLUG (SOME MODELS)
58. GASKET— PRI. FUEL BOWL	78. GASKET— SEC. FUEL BOWL
59. METER BODY FILLER— PRI. (SOME MODELS)	79. METERING BLOCK— SEC.
60. METERING BLOCK— PRI.	80. JET (2)— MAIN
61. JET (2)— PRI. MAIN	81. CAP (2)— IDLE LIMITER
62. VALVE— ENRICHMENT	82. NEEDLE (2)— IDLE ADJUSTING
63. GASKET— ENRICHMENT VALVE	83. GASKET (2)— IDLE ADJ. NEEDLE
64. GASKET— PRI. METERING BLOCK.	84. GASKET— SEC. METERING BODY
65. TUBE— PUMP TRANSFER	85. SCREW & LOCKWASHER (8)— THROTTLE BODY.
66. O-RING (2)— TRANSFER TUBE	86. THROTTLE BODY ASSY.
67. TUBE— FUEL LINE	87. GASKET— THROTTLE BODY
68. O-RING (2)— FUEL LINE TUBE	88. SCREW— PUMP DISCHARGE NOZZLE.
69. SCREW (4)— SEC. FUEL BOWL	89. GASKET (2)— PUMP NOZZLE
70. GASKET (4)— SEC. FUEL BOWL SCREW.	90. NOZZLE— PUMP DISC.
71. BOWL— SEC. FUEL	91. NEEDLE— PUMP DISC.
72. BAFFLE PLATE.	92. MAIN BODY ASSEMBLY.

CLEANING

CLEANING MUST BE DONE WITH CARBURETOR DISASSEMBLED. SOAK PARTS LONG ENOUGH TO SOFTEN AND REMOVE ALL FOREIGN MATERIAL. USE A CARBURETOR CLEANING SOLVENT MAKE SURE THE THROTTLE BORES ARE FREE OF ALL CARBON AND VARNISH DEPOSITS. RINSE OFF IN SUITABLE SOLVENT. BLOW OUT ALL PASSAGES IN CASTINGS WITH COMPRESSED AIR AND CHECK CAREFULLY TO INSURE THOROUGH CLEANING OF OBSCURE AREAS. CAUTION: DO NOT SOAK FLOATS, SOLENOIDS OR PARTS CONTAINING RUBBER MATERIAL IN CLEANING SOLVENTS.

REASSEMBLE

REASSEMBLE IN REVERSE ORDER OF DISASSEMBLY. NOTE: SPECIAL INSTRUCTIONS AND FOLLOW NUMERICAL OUTLINE IN MAKING ADJUSTMENTS NECESSARY FOR CARBURETOR BEING SERVICE.

INSTRUCTION SHEET HOLLEY CARBURETOR MODEL 4150 EG

GM PRODUCTS

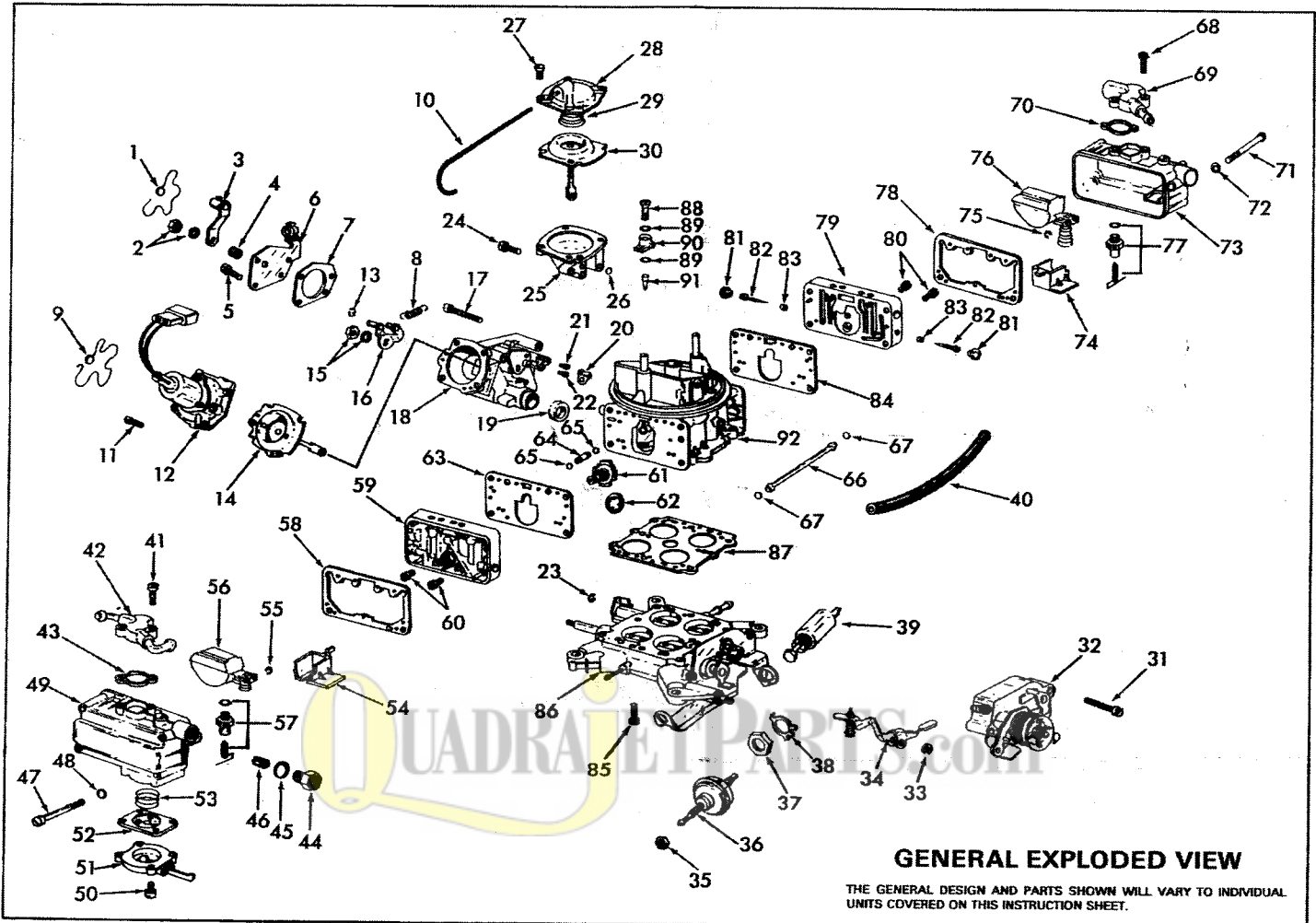

GENERAL EXPLODED VIEW

THE GENERAL DESIGN AND PARTS SHOWN WILL VARY TO INDIVIDUAL UNITS COVERED ON THIS INSTRUCTION SHEET.

DISASSEMBLY

USE EXPLODED VIEW AS A GUIDE. THE NUMERICAL SEQUENCE MAY GENERALLY BE FOLLOWED TO DISASSEMBLE UNIT FAR ENOUGH TO PERMIT CLEANING AND INSPECTION. NOTE: ON SOME MODELS UNHOOK HEAVY SAFETY SPRING ON THROTTLE LEVER ASSEMBLY (32) FOR EASIER ACCESS TO (31) HOLDING ASSEMBLY TO CARBURETOR. RECORD JET SIZES AND LOCATION FOR REASSEMBLY.

NOMENCLATURE

REF. NO.	REF. NO.
1. SEAL & WIRE—COVER (WHEN USED)	28. COVER—SEC. DIAPHRAGM
2. NUT & LOCKWASHER—LEVER	29. SPRING—SEC. DIAPHRAGM
3. LEVER—CHOKE	30. DIAPHRAGM—SECONDARY
4. SEAL—DUST	31. SCREW & LOCKWASHER (2)—THROTTLE OPERATING SHAFT HOUSING
5. SCREW & LOCKWASHER (4)—COVER	32. HOUSING ASSY.—THROTTLE OPERATING LEVER
6. COVER—GOVERNOR HOUSING	33. E-CLIP—LEVER
7. GASKET—GOVERNOR COVER	34. LEVER ASSY.—PUMP
8. SPRING—GOVERNOR	35. NUT—MODULATOR
9. SEAL & WIRE—DIAPHRAGM COVER (WHEN USED)	36. MODULATOR—THROTTLE
10. HOSE—GOV. TO SEC. DIAPHRAGM COVER	37. NUT—SOLENOID
11. SCREW & LOCKWASHER (4)—DIAPHRAGM & SOLENOID COVER	38. LOCKTAB WASHER—SOLENOID
12. COVER ASSY.—DIAPHRAGM & SOLENOID	39. SOLENOID—THROTTLE
13. E-CLIP—DIAPHRAGM STEM RETAINER	40. HOSE—VENT CROSS OVER
14. DIAPHRAGM ASSEMBLY	41. SCREW & LOCKWASHER (2)—PRI. VENT COVER
15. NUT & LOCKWASHER—GOV. LEVER	42. VENT COVER—PRIMARY
16. LEVER—GOVERNOR	43. GASKET—VENT COVER
17. SCREW & LOCKWASHER (3)—GOVERNOR HOUSING	44. FITTING—FUEL INLET
18. GOV. HOUSING ASSEMBLY	45. GASKET—FITTING
19. SEAL—GOV. HOUSING	46. SCREEN—FUEL INLET
20. GASKET—GOV. HOUSING	47. SCREW (4)—PRI. FUEL BOWL
21. JET "A"—GOV. HOUSING	48. GASKET (4)—PRI. FUEL BOWL SCREW
22. JET "B"—GOV. HOUSING	49. BOWL—PRI. FUEL
23. E-CLIP—SEC. DIAPH. STEM	50. SCREW & LOCKWASHER (4)—COVER
24. SCREW & LOCKWASHER (3)—SEC. DIAPH. HOUSING	51. COVER ASSY.—PUMP DIAPHRAGM
25. SECONDARY DIAPHRAGM HOUSING	52. DIAPHRAGM ASSY.—PUMP
26. GASKET—SEC. DIAPH. HOUSING	53. SPRING—DIAPHRAGM
27. SCREW & LOCKWASHER (4)—COVER	54. BAFFLE PLATE
	55. E-CLIP—FLOAT
	56. FLOAT & SPRING ASSY.—PRI.
	57. NEEDLE & SEAT ASSY.—PRI.

NOMENCLATURE

REF. NO.	REF. NO.
58. GASKET—PRI. FUEL BOWL	76. FLOAT & SPRING ASSY.—SEC.
59. METERING BLOCK—PRI.	77. NEEDLE & SEAT ASSY.—SEC.
60. JET (2)—PRI. MAIN	78. GASKET—SEC. FUEL BOWL
61. VALVE—ENRICHMENT	79. METERING BLOCK—SEC.
62. GASKET—ENRICHMENT VALVE	80. JET (2)—SEC. MAIN
63. GASKET—PRI. METERING BLOCK	81. CAP (2)—IDLE LIMITER
64. TUBE—PUMP TRANSFER	82. NEEDLE (2)—IDLE ADJUSTING
65. O-RING (2)—TRANSFER TUBE	83. GASKET (2)—IDLE ADJUSTING NEEDLE
66. TUBE—FUEL LINE	84. GASKET—SEC. METERING BODY
67. O-RING (2)—FUEL LINE TUBE	85. SCREW & LOCKWASHER (2)—THROTTLE BODY
68. SCREW & LOCKWASHER (2)—SEC. VENT COVER	86. THROTTLE BODY ASSY.
69. VENT COVER—SECONDARY	87. GASKET—THROTTLE BODY
70. GASKET—VENT COVER	88. SCREW—PUMP DISC. NOZZLE
71. SCREW (4)—SEC. FUEL BOWL	89. GASKET (2)—PUMP NOZZLE
72. GASKET (4)—SEC. FUEL BOWL SCREW	90. NOZZLE—PUMP DISC.
73. BOWL—SEC. FUEL	91. NEEDLE—PUMP DISC.
74. BAFFLE PLATE	92. MAIN BODY ASSEMBLY
75. E-CLIP—FLOAT	

CLEANING

CLEANING MUST BE DONE WITH CARBURETOR DISASSEMBLED. SOAK PARTS LONG ENOUGH TO SOFTEN AND REMOVE ALL FOREIGN MATERIAL. USE A CARBURETOR CLEANING SOLVENT. MAKE SURE THROTTLE BORES ARE FREE OF ALL CARBON AND VARNISH DEPOSITS. RINSE OFF IN SUITABLE SOLVENT. BLOW OUT ALL PASSAGES IN CASTINGS WITH COMPRESSED AIR AND CHECK CAREFULLY TO INSURE THOROUGH CLEANING OF OBSCURE AREAS. CAUTION: DO NOT SOAK FLOATS: SOLENOIDS, OR PARTS CONTAINING RUBBER MATERIAL IN CLEANING SOLVENT.

REASSEMBLE

REASSEMBLE IN REVERSE ORDER OF DISASSEMBLY. NOTE: SPECIAL INSTRUCTIONS AND FOLLOW NUMERICAL OUTLINE IN MAKING ADJUSTMENTS NECESSARY FOR CARBURETOR BEING SERVICED.

ADJUSTMENTS

SPECIAL INSTRUCTIONS

SCREWS LISTED BELOW MUST BE TIGHTENED IN THREE STAGES CROSSWISE TO ARRIVE AT THE CORRECT TORQUE.

THROTTLE BODY GASKET (87) MAKE SURE HOLES ARE PROPERLY MATCHED TO THROTTLE BODY. TORQUE BODY SCREWS TO 50 INCH POUNDS.

IDLE ADJUSTING NEEDLES (82) TURN IN UNTIL LIGHTLY SEATED, THEN BACK OUT ONE TURN. (DO NOT INSTALL IDLE LIMITER CAPS AT THIS TIME.)

PRIMARY & SECONDARY FUEL BOWL (48)-(71) OR (49)-(73) BEFORE INSTALLING MAKE DRY FLOAT LEVEL ADJUSTMENT.

BOWL SCREW INSTALLATION (46)-(69) OR (47)-(71)-INSTALL GASKETS (47)-(70) OR (48)-(72) ON SCREWS BEFORE INSTALLING. THEN TORQUE EVENLY IN STAGES TO 40 INCH POUNDS.

FUEL LINE TUBE (67) OR (68) INSTALL O-RINGS (68) OR (67) ON THE EXTREME ENDS OF THE TUBE, THEY WILL ROLL ON THE TUBE WHEN INSTALLING THE FUEL BOWL.

ENRICHMENT VALVE (61)-(62) INSTALLATION- TORQUE TO 100 INCH POUNDS.

GOVERNOR DIAPHRAGM (13) OR (14)- INSTALLATION SEE FIGURE 7

